



DEPARTMENT OF PARKS AND RECREATION  
OFFICE OF HISTORIC PRESERVATION

Armando Quintero, Director

Julianne Polanco, State Historic Preservation Officer  
1725 23rd Street, Suite 100, Sacramento, CA 95816-7100  
Telephone: (916) 445-7000 FAX: (916) 445-7053  
calshpo.ohp@parks.ca.gov [www.ohp.parks.ca.gov](http://www.ohp.parks.ca.gov)

022-23M



September 15, 2023

Santa Cruz County Board of Supervisors  
Clerk of the Board  
701 Ocean Street, Room 500  
Santa Cruz, CA 95060

**RE: California Point of Historical Interest Nomination of  
Headquarters Administration Building Request for Removal**

Dear Board of Supervisors:

The State Historical Resources Commission (Commission) is scheduled to take action on this nomination at its next regular quarterly meeting. (Details regarding the meeting are on the enclosed notice.) At the meeting, any interested party, government entity, or member of the public may address the Commission regarding the nomination prior to the Commission taking action on the nomination. Any interested party, government entity, or member of the public may also submit to the Commission written comments regarding the nomination. Comments should be submitted to California State Parks, Attn: Office of Historic Preservation, Julianne Polanco, State Historic Preservation Officer, Post Office Box 942896, Sacramento, California 92496-0001. So that the Commission may have adequate time to consider such comments, it is requested, but not required, that such comments be submitted to the State Historic Preservation Officer 15 days before the meeting.

California Points of Historical Interest (Points) are properties of local interest recognized for their historical significance. The criteria governing the historical designation of a property is that the property must be the first, last, only, or most significant of its kind in a local geographical area. If the property has lost its historic integrity it can be listed as a site. Points designated after December 1997 and recommended by the Commission are also listed in the California Register of Historical Resources. Resources listed in or eligible for listing in the California Register must be given consideration in the California Environmental Quality Act ("CEQA") review process.

If you have questions, please contact the Registration Unit at (916) 445-7008.

Sincerely,

Julianne Polanco  
State Historic Preservation Officer

THIS NOTICE HAS BEEN POSTED AT THE CLERK  
OF THE BOARD OF SUPERVISORS OFFICE FOR A  
PERIOD COMMENCING 10/16 2023  
AND ENDING 11/15 2023



**DEPARTMENT OF PARKS AND RECREATION  
OFFICE OF HISTORIC PRESERVATION**

Armando Quintero, Director

Julianne Polanco, State Historic Preservation Officer  
1725 23rd Street, Suite 100, Sacramento, CA 95816-7100  
Telephone: (916) 445-7000 FAX: (916) 445-7053  
calshpo.ohp@parks.ca.gov [www.ohp.parks.ca.gov](http://www.ohp.parks.ca.gov)

September 15, 2023

Santa Cruz County Board of Supervisors  
Clerk of the Board  
701 Ocean Street, Room 500  
Santa Cruz, CA 95060

**RE: California Point of Historical Interest Nomination of  
Site of Headquarters Administration Building**

Dear Board of Supervisors:

The State Historical Resources Commission (Commission) is scheduled to take action on this nomination at its next regular quarterly meeting. (Details regarding the meeting are on the enclosed notice.) At the meeting, any interested party, government entity, or member of the public may address the Commission regarding the nomination prior to the Commission taking action on the nomination. Any interested party, government entity, or member of the public may also submit to the Commission written comments regarding the nomination. Comments should be submitted to California State Parks, Attn: Office of Historic Preservation, Julianne Polanco, State Historic Preservation Officer, Post Office Box 942896, Sacramento, California 92496-0001. So that the Commission may have adequate time to consider such comments, it is requested, but not required, that such comments be submitted to the State Historic Preservation Officer 15 days before the meeting.

California Points of Historical Interest (Points) are properties of local interest recognized for their historical significance. The criteria governing the historical designation of a property is that the property must be the first, last, only, or most significant of its kind in a local geographical area. If the property has lost its historic integrity it can be listed as a site. Points designated after December 1997 and recommended by the Commission are also listed in the California Register of Historical Resources. Resources listed in or eligible for listing in the California Register must be given consideration in the California Environmental Quality Act ("CEQA") review process.

If you have questions, please contact the Registration Unit at (916) 445-7008.

Sincerely,

Julianne Polanco  
State Historic Preservation Officer

## APPLICATION FOR REGISTRATION

**CALIFORNIA HISTORICAL LANDMARK**  
(Results in Automatic listing in the California Register)

**CALIFORNIA POINT OF HISTORICAL INTEREST**

NAME OF HISTORIC PROPERTY

Site of Headquarters Administration Building

ADDRESS

xxx, Big Basin State Historic Park

CITY/STATE/ZIP CODE

Boulder Creek / California / 95006

COUNTY

Santa Cruz

ASSESSOR'S PARCEL NO.

N/A

NAME OF OWNER OF HISTORIC PROPERTY

California State Parks

ADDRESS

715 P Street

CITY/STATE/ZIP CODE

Sacramento, CA 95814

NAME OF APPLICANT

Kathleen Kennedy [Kathleen.Kennedy@parks.ca.gov]

APPLICANT TELEPHONE NO.

916-952-2579

ADDRESS

Cultural Resources Division, 715 P Street

CITY/STATE/ZIP CODE

Sacramento, CA 95814

RECOMMENDED BY CHAIR, STATE HISTORICAL RESOURCES COMMISSION

DATE

APPROVED BY DIRECTOR, CALIFORNIA DEPARTMENT OF PARKS AND RECREATION

DATE

DESIGNATION NO.



**P1. Other Identifier:** Visitor Center; Facility #406A1100001

**\*P2. Location:**  Not for Publication  Unrestricted **\*a. County:** Santa Cruz

and (P2b and P2c or P2d. Attach a Location Map as necessary.)

**\*b. USGS 7.5' Quad:** Big Basin, California **Date:** 1955, Photo Revised 1968

T 9S; R 3W; NW¼ of NW¼ of Sec 8; M.D. B.M.

c. Address: 21600 Big Basin Way

City: Boulder Creek

Zip: 95006

d. UTM: Zone: 10; 569,190 mE/ 4,114,070 mN (G.P.S.)

e. Other Locational Data: Big Basin Redwoods State Park Elevation: 1,008.7 feet

**\*P3a. Description:** (Describe resource and its major elements. Include design, materials, condition, alterations, size, setting, and boundaries)

Constructed by Civilian Conservation Corps enrollees in 1935, the Headquarters Administration Building was destroyed in the 2020 CZU Lighting Complex Fire. The fire left the foundation, chimney, and stone steps. After cleanup, all that remains are the stone steps and an approximately 1.2 meter deep concrete patio at the southwest end of the original building, bordered by newly installed split rail fencing and an "Area closed" sign hanging between the metal handrails that border the steps. Ten steps rise approximately 1.5 meters and run approximately 4 meters. The concrete patio is 3.7 m x 3.7 m and has a strip of granite pavers running east-west.

**\*P3b. Resource Attributes:** (List attributes and codes) HP35 New Deal Public Works Project

**\*P4. Resources Present:**  Building  Structure  Object  Site  District  Element of District  Other (Isolates, etc.)

P5a. Photo or Drawing



**P5b. Description of Photo:**  
Headquarters Admin Building  
steps facing NE, 8/31/2023.

**\*P6. Date Constructed/Age and Sources:**  Historic  
 Prehistoric  Both  
1935, California State Parks  
Records.

**\*P7. Owner and Address:**  
California State Parks  
PO Box 942896  
Sacramento, CA 94296

**\*P8. Recorded by:**  
Michael Grone, CSP Julia  
Hartman, CSP

**\*P9. Date Recorded:** 08/31/2023

**\*P10. Survey Type:** Focused

**\*P11. Report Citation:** None

**\*Attachments:**  NONE  Location Map  Sketch Map  Continuation Sheet  Building, Structure, and Object Record  Archaeological Record  District Record  Linear Feature Record  Milling Station Record  Rock Art Record  Artifact Record  Photograph Record  Other (List):

Page 2 of 8

\*Resource Name or #: Site of Headquarters Administration Building

\*A1. Dimensions: a. Length: 8 m.  b. Width: 5 m.

Method of Measurement:  Paced  Taped  Visual estimate  Other:

Method of Determination (Check any that apply.):  Artifacts  Features  Soil  Vegetation  Topography  
 Cut bank  Animal burrow  Excavation  Property boundary  Other (Explain):

Reliability of Determination:  High  Medium  Low Explain:

Limitations (Check any that apply):  Restricted access  Paved/built over  Site limits incompletely defined  
 Disturbances  Vegetation  Other (Explain):

A2. Depth: 1.2 meters (patio)  None  Unknown Method of Determination:

\*A3. Human Remains:  Present  Absent  Possible  Unknown (Explain):

\*A4. Features (Number, briefly describe, indicate size, list associated cultural constituents, and show location of each feature on sketch map.):

After fire cleanup, all that remains are the stone steps and a 1.2 meter deep concrete patio at the southwest end of the original building, bordered by newly installed split rail fencing and an "Area closed" sign hanging between the metal handrails that border the steps. Ten steps rise approximately 1.5 meters and run approximately 4 meters. The concrete patio is 3.7 m x 3.7 m and has a strip of granite pavers running east-west. See attached photos and Sketch Map.

\*A5. Cultural Constituents (Describe and quantify artifacts, ecofacts, cultural residues, etc., not associated with features.):

The surrounding area is fenced off by split rail fencing, and the ground is covered with wood chips.

\*A6. Were Specimens Collected?  No  Yes (If yes, attach Artifact Record or catalog and identify where specimens are curated.)

\*A7. Site Condition:  Good  Fair  Poor (Describe disturbances.):

\*A8. Nearest Water (Type, distance, and direction.): Opal Creek, roughly 200 meters

\*A9. Elevation: 1012 feet

A10. Environmental Setting (Describe culturally relevant variables such as vegetation, fauna, soils, geology, landform, slope, aspect, exposure, etc.): Fronted by a public highway within a redwood forest.

A11. Historical Information:

CCC enrollees constructed the building in 1935. It operated as the park administration building and visitor center from 1935 to 2020, when it was destroyed in the 2020 CZU Lightning Complex Fire.

On August 16, 2020, lightning strikes started fires including the CZU Lightning Complex Fire in Santa Cruz County. The fire actively burned for thirty-seven days and consumed 86,509 acres across the mountains in Santa Cruz and San Mateo Counties. In Big Basin Redwoods State Park, the fire spared one residence in Lower Sky Meadow and the water treatment facility. All other buildings were lost.

The administration building was reduced to a board formed concrete perimeter foundation approximately 1.2 meter deep attached to the front patio, which features stone facing and is accessed by original stone steps on the southwest end. After post-fire cleanup, the steps and patio are all that remain. All other elements of the building were destroyed or have been removed.



Page 3 of 8

\*Resource Name or #: Site of Headquarters Administration Building

**Registration Status**

The Headquarters Administration Building (NRHP #15000914) was listed on the National Register of Historic Places in 2015 under Criteria A and C at the state level of significance in the areas of Politics/Government and Architecture. The building no longer retains its design, materials, craftsmanship, or massing. The site of the building no longer conveys the association with the Civilian Conservation Corps for which it was listed under Criterion A and no longer exhibits the character defining features of the Park Rustic style that made it eligible for listing under Criterion C.

\*A12. Age:  Prehistoric  Protohistoric  1542-1769  1769-1848  1848-1880  1880-1914  1914-1945  Post 1945  Undetermined **Describe position in regional prehistoric chronology or factual historic dates if known:**

A13. Interpretations (Discuss data potential, function[s], ethnic affiliation, and other interpretations):

The Headquarters Administration Building no longer retains the original design, materials, or ability to convey association with the CCC or character-defining features of the Parks Rustic Style. Originally listed as a building on the National Register, the subsequent Point of Historical Interest is categorized as a site.

A14. Remarks:

A15. References (Documents, informants, maps, and other references): Amanda Blosser and Kathleen Kennedy, Headquarters Administration Building National Register Nomination. 2015.

A16. Photographs (List subjects, direction of view, and accession numbers or attach a Photograph Record.):  
See photo log and continuation sheets.

Original Media/Negatives Kept at: Santa Cruz District Headquarters, California State Parks

\*A17. Form Prepared by: Michael Grone

Date: 09/11/2023

**Affiliation and Address:** Santa Cruz District of Parks and Recreation, 303 North Big Trees Road, Felton, CA 95018

**\*Required information**

Page 4 of 8

Project Name: Site of Headquarters Administration Building

Name of Property: Site of Headquarters Administration Building  
City or Vicinity: Boulder Creek  
County: Santa Cruz State: California  
Photographer: Michael Grone and Julia Hartman, using iPhone Pro Max  
Date Photographed: August 31, 2023

Description of Photograph(s) and number, include description of view indicating camera direction:

- 1 of 3 Headquarters Administration Building steps, view northeast
- 2 of 3 Concrete patio and steps, view south
- 3 of 3 Concrete patio and steps, view northwest

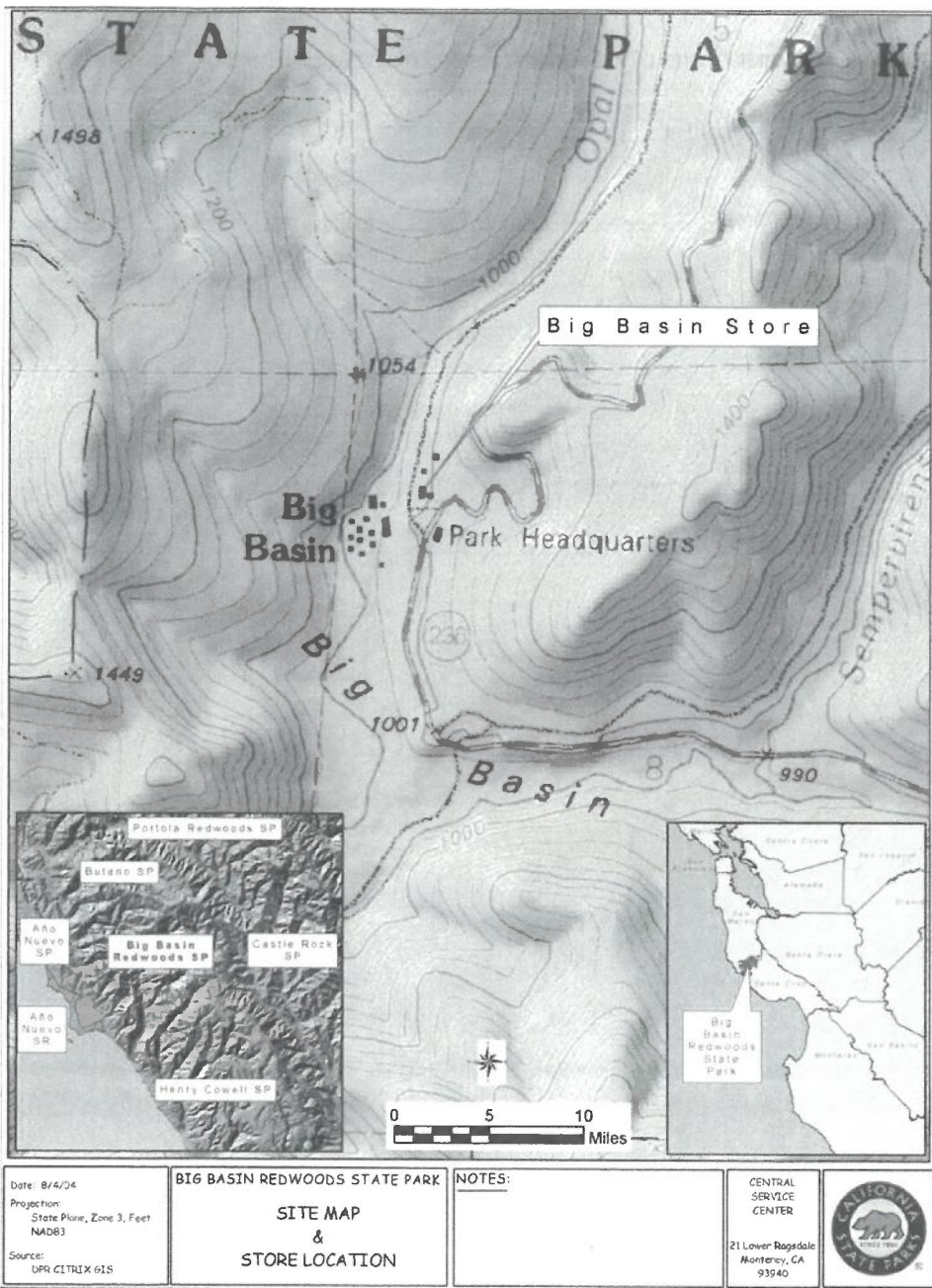



Stone steps and concrete patio at SW corner of site of Headquarters Administration Building

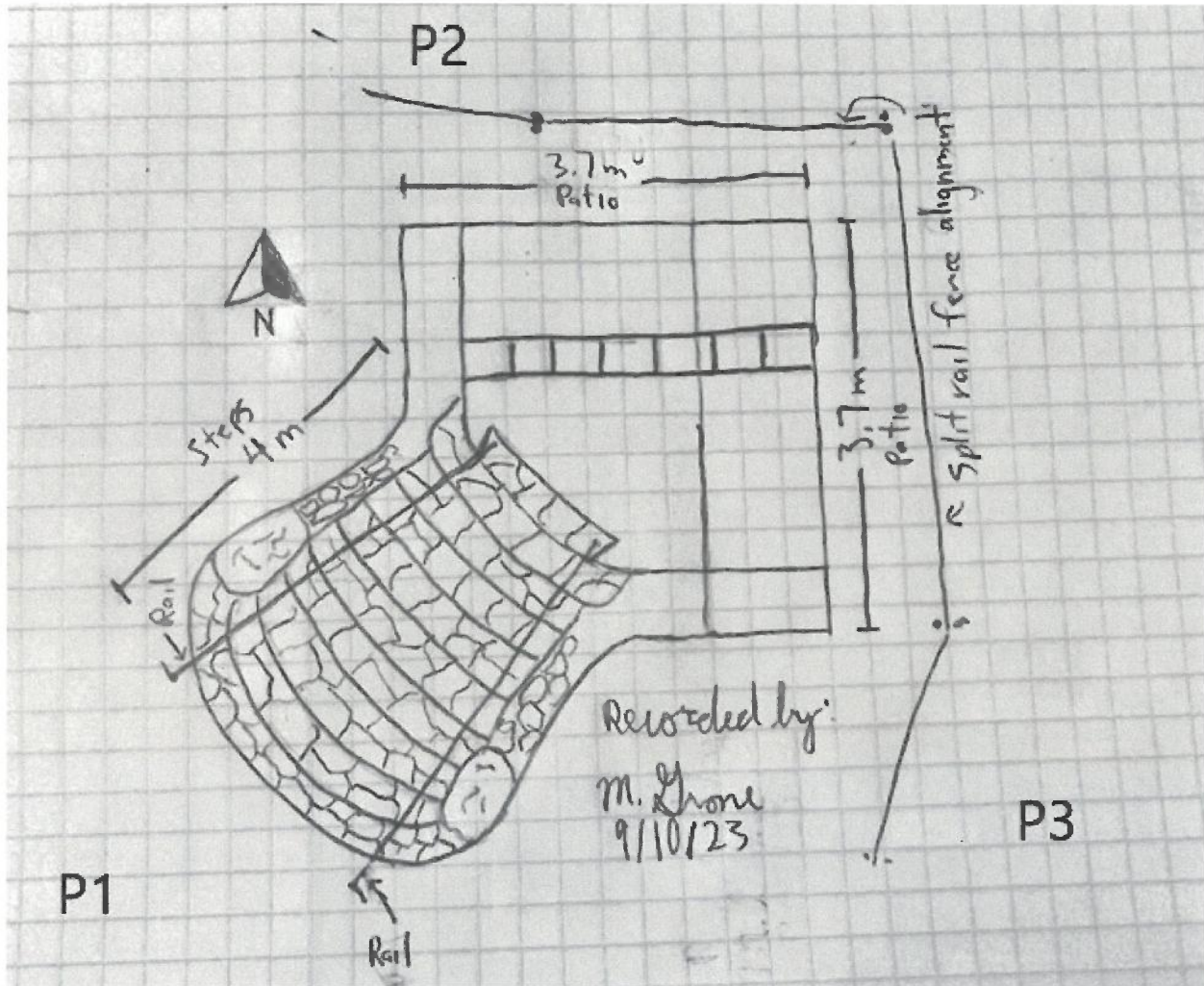

# CONTINUATION SHEET

Page 6 of 8

\*Resource Name or #: Site of Headquarters Administration Building

\*Recorded by: Michael Grone \*Date 8/31/2023  Continuation  Update

Photo 1 Headquarters Administration Building steps, view northeast



Photo 2 Concrete patio and steps, view south





## CONTINUATION SHEET

Page 7 of 8

\*Resource Name or #: Site of Headquarters Administration Building

\*Recorded by: Michael Grone \*Date 08/31/2023  Continuation  Update

Photo 3 Concrete patio and steps, view northwest





